

QUICK SET-UP GUIDE

Valura 1-3 kVA IBB

APPLICATIONS

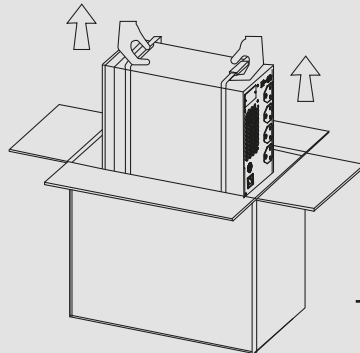
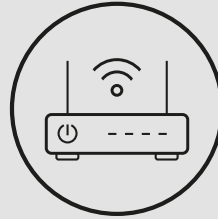
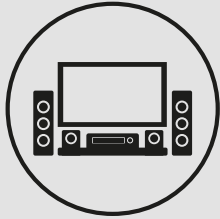

Step 1

Use the handle and carefully lift the product.

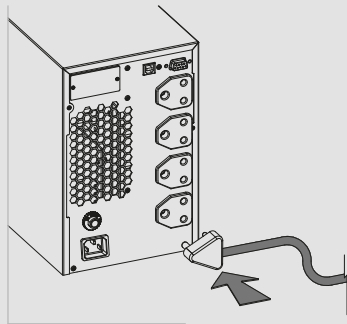

Step 2

Connect the application input plug to the UPS output socket, use 3-pin 6A 240 V AC plug before switching the UPS on.

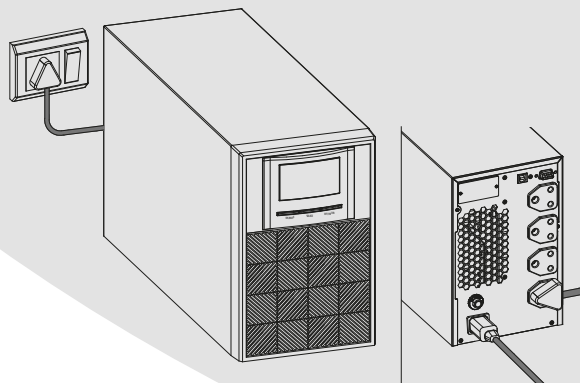

Step 3

Connect the UPS AC input power plug to socket before switching the UPS ON (Use 3-pin 6A 240 V AC plug for 1 kVA. Use 3-pin 16A 240 V AC plug for 2 and 3 kVA)

**NEW ENERGY
TO POWER**

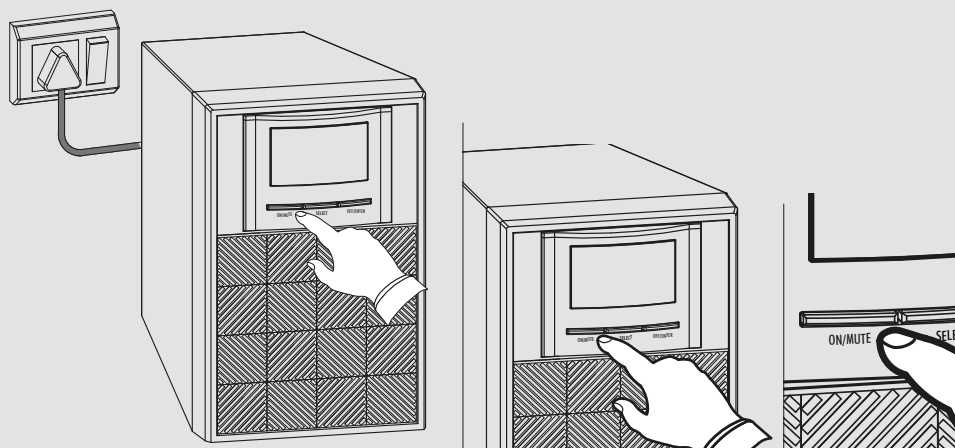

Step 4

Press the ON/Mute button in the front panel for 2 seconds to switch the UPS ON.

Display status

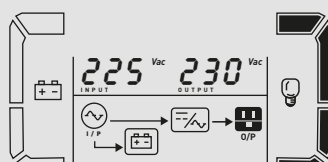

Mains mode
50 - 75%

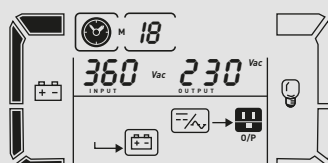

Battery mode
50 - 75%

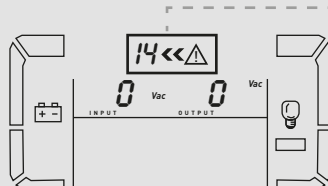

14 << error code
Short-circuit warning

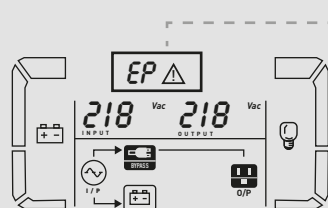

EP error code
Temperature warning

Note: Seek service support for further assistance.



Do's

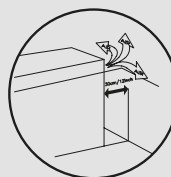

Keep at least 30 cms.
clear distance between
the rear panel of the UPS
and the wall

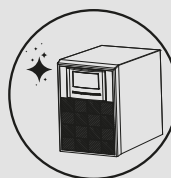

Keep the UPS and
its nearby area clean

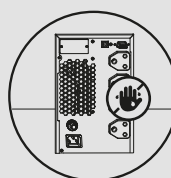

Do dry your hands before
operating the UPS.



Don'ts

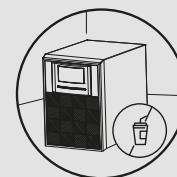

Do not eat or drink
near the UPS area.

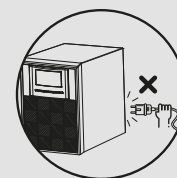

Do not pull any wires
connected to the UPS

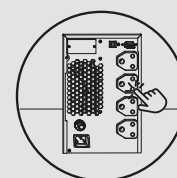

Do not put fingers
into any slot

Scan the QR code
for warranty
registration

